

Dear Music Lover,

Thank you for purchasing high performance and high quality **mhi** Image Enhancer for MM01A Evidence Speaker System. The unique features of this product enhance clear Imaging and mid-Bass. The image enhancer has a hardwood half-dome to help smooth dispersion of mid-bass. You are able to improve the Room Acoustic with "Image Enhancer" in case of "too much reflection" or "too little reflection".

We are confident that once you listen with these Image Enhancers you will hear the difference.

Image Enhancer for "Evidence MM01A" Made of DuPont "CORIAN" (man-made marble)

Specifications

Dimensions

----- W 120 mm x H 239.5 mm x D 73 mm
Stick out from MM01A Evidence
--- (from cabinet) Top 20mm, Back 73 mm

Material ----- DuPont "CORIAN"
Cameo White, 1/2 + 1/6 inch

Weight ----- 0.47 kg (1.0 lbs.) each



When you mount Image Enhancer,
please use banana connector.
(not able to connect directly)

This product is not injection molding.
This is fabricated with CORIAN panels
by adhesive. If you see glue line and/or
joint line, it is not defective.

CORIAN Reflector
enhance smooth reflection

Hardwood Half Dome
enhance smooth dispersion

Holes for mounting

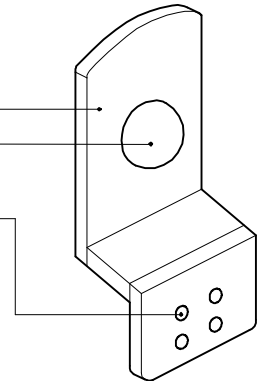

Improper Usage

Protect your investments from performance & appearance damage

< Excessive Heat >

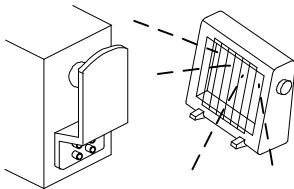

< Wash in/under
the Water >

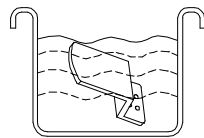

< Drop on the Floor >

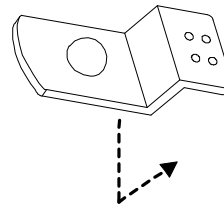

< Excessive Force >

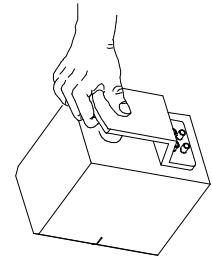

Limited Warranty

Your mhi image enhancers are warranted to be free of defects for **thirty (30) days** after original purchase. If a image enhancer fails to perform during the warranty period, we will repair or replace it at our option. The warranty does not apply to damage caused by physical abuse to the image enhancer, or unauthorized modifications or repairs performed by anybody except mhi or its dealers, or designated service agents. This warranty specifically excludes consequential damage to other devices. mhi is not responsible for any consequential damage.

If a image enhancer requires service, you may either consult your mhi dealer, or send it directly to mhi. If you chose to return it to mhi, please telephone first. If we can diagnose the problem by telephone, we may be able to tell you how to fix it without the inconvenience and expense of packing and shipping the image enhancer. Please do not send us your image enhancer until we give you a return authorization. You are responsible for the cost of shipping to mhi; if the product is still under warranty, we will return it to you at our expense. You can reach mhi service department at this address:

mhi
1235 Countess Drive
Corona, California 92882 USA
Phone: 951-898-1121 / Fax: 951-898-5627 / e-mail: m_h_i_@msn.com

YOUR PRODUCTS' SERIAL #

Outside the United States and Canada, please contact your dealer first.

Please use the original packing materials when you ship a product to us. If you did not save the original box, let us know when you request a return authorization, and we will send you another box. We will charge you for the replacement box at our cost.

MOUNTING PROCEDURES

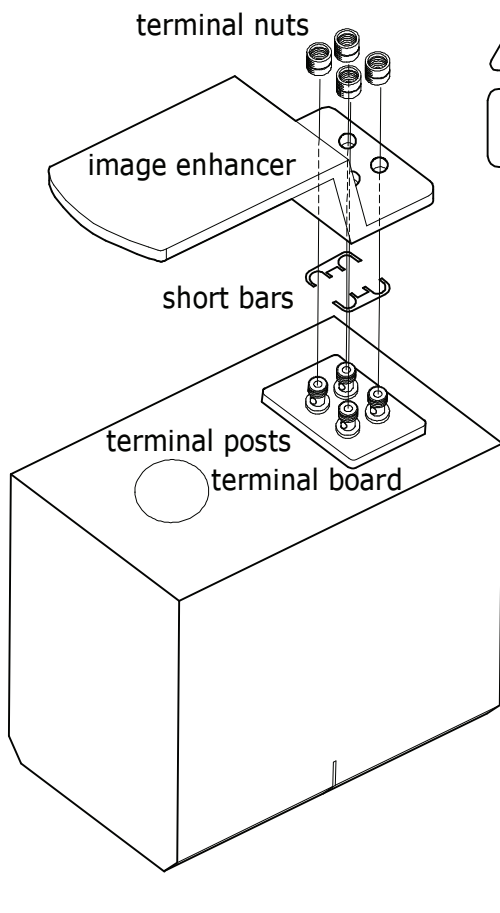

Be aware of the terminal nuts direction



CORRECT

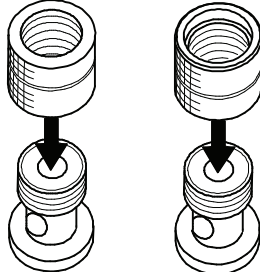

terminal posts

STEP 1

Lay down the speaker system with the grille on the carpet.

STEP 2

Remove the terminal nuts and the short bars from the terminal board

FOR SINGLE WIRING

STEP 3

Mount the short bars, the image enhancer and the terminal nuts on the the terminal posts



Be aware the short bars to keep correct location

FOR BI-WIRING

STEP 3

Mount the image enhancer and the terminal nuts on the the terminal posts



Do not mount the short bars



When you mount Image Enhancer, please use banana connector. (not able to connect directly)

DIMENSIONS

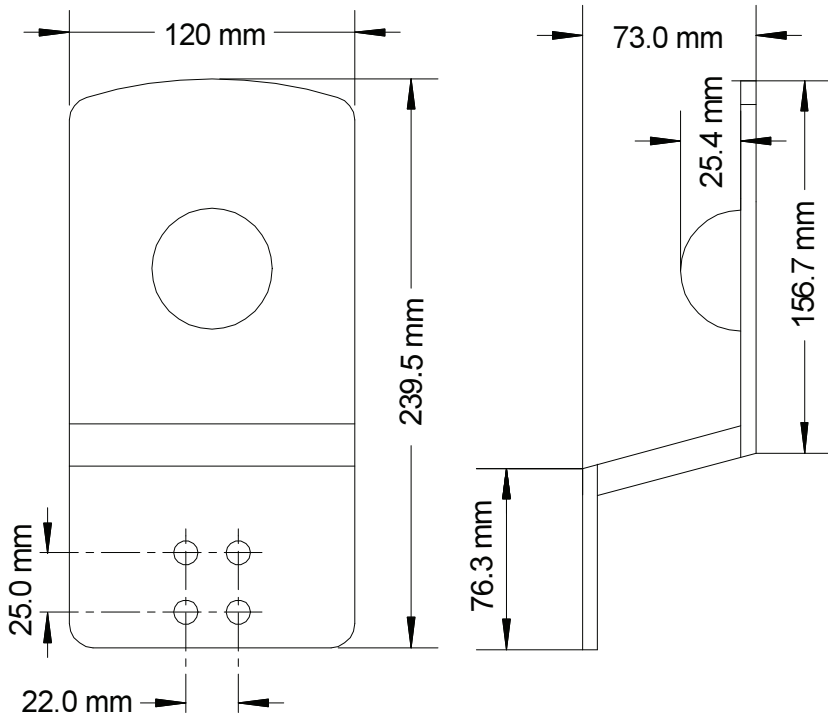

ROOM ACOUSTIC IMPROVEMENT WITH "IMAGE ENHANCER"

<Too much reflection>
unclear imaging

<appropriate reflection>
clear imaging
acoustic absorbent panels + "IMAGE ENHANCER"

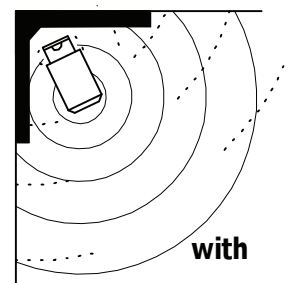
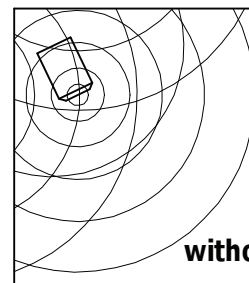

<Too little reflection>
less mid-bass

<enhancing reflection>
more mid-bass
+ "IMAGE ENHANCER"

